



APRIL 2019 | [PROBUILDER.COM](http://PROBUILDER.COM)

# Professional Builder<sup>®</sup>

## SERVING SENIORS

### ALSO IN THIS ISSUE

The Off-Site Argument / 17  
Leveraging Local SEO / 26  
Data-Driven Builders / 32

# OUTDOOR LIVING

## 2019 HOUSE REVIEW THEMES

- MAY** Small Homes That Live Big
- JUNE** Housing Options for Boomers
- JULY** Starter Homes
- AUGUST** New Urbanism for the Small Builder
- SEPTEMBER** Kitchens
- OCTOBER** Contemporary / Modern Homes
- NOVEMBER** Master Baths
- DECEMBER** On the Boards

Blurring the lines for all seasons, these designs are careful and inviting, no matter the weather

By Larry W. Garnett, FAIBD, House Review Lead Designer

Carefully designed outdoor spaces can greatly enhance adjacent indoor square footage by providing additional living areas. While strategically placed courtyards bring natural light to rooms located near the central portion of a home, expansive porches and loggias offer functional spaces overlooking pools and outdoor kitchens.

Although these outdoor areas add value to single-family designs, they also become essential for amenity centers and clubhouses. The following designs from our House Review team present several unique ways to merge the indoor and outdoor living areas.



SITE PLAN





## THE SUMMIT CLUB

### ARCHITECT

Robert Hidey Architects  
ahidey@roberthidey.com  
949.655.1550

### PLAN SIZE

Width: 69 feet, 2 inches  
Length: 113 feet, 3 inches  
Living area: 7,981 sf

The luxury coastal village of Sea Summit was developed for move-up and established families, as well as lifestyle buyers. Carved into sandstone bluffs rising 100 feet above the Pacific Ocean, it occupies the last parcel of undeveloped land in the popular seaside town of San Clemente, Calif. The Summit Club is situated on a prime bluff-top site and was designed with a cohesive blend of traditional materials and intricate detailing to reflect the rich heritage and charisma of this seaside hamlet.

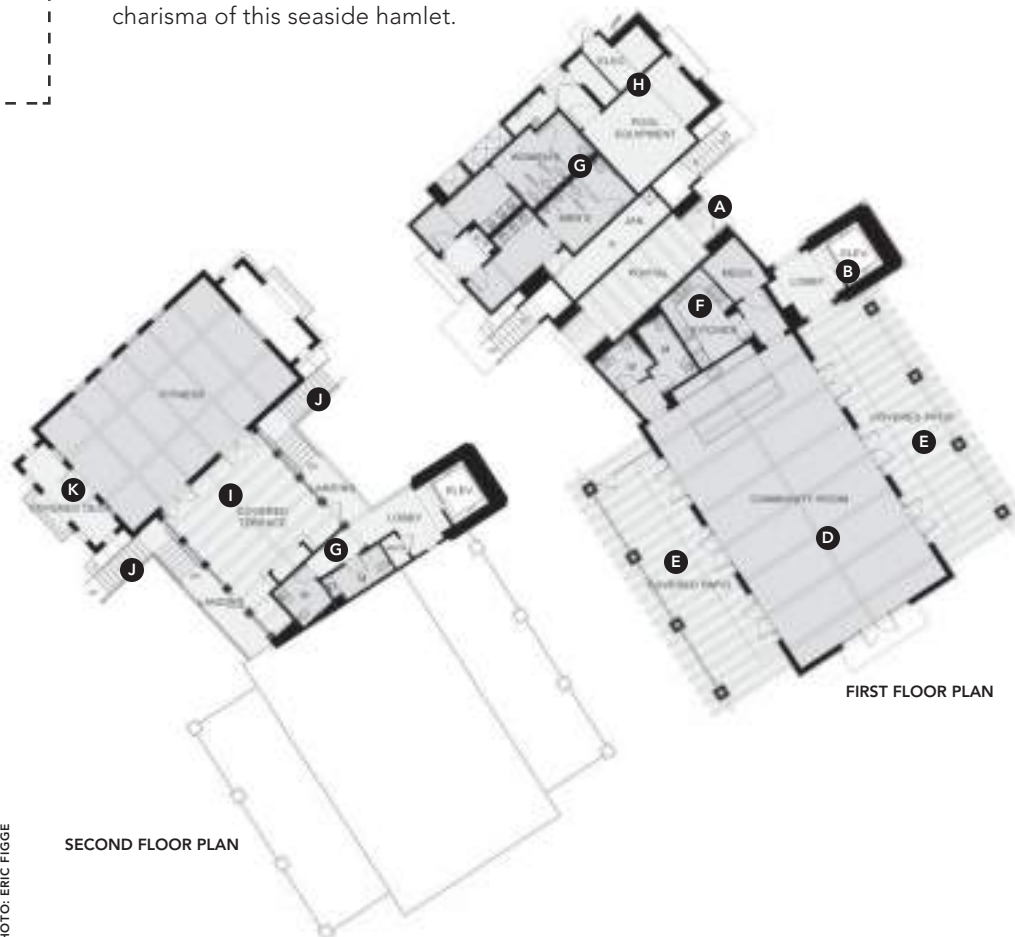

- A** Entry sequence leads from parking lot through covered walkway or portal to pool area
- B** The landmark Spanish Mediterranean-style tower houses elevator to second story
- C** Four cabanas flank the wedge-shaped pool, with an outdoor shower located on the building's side (see site plan at left)
- D** Community room entry through covered patios (E) on both sides of the building; seven pairs of French doors offer bluff and ocean views
- E** Covered patios at either side of community room (D), oriented to pool and parking areas
- F** Catering kitchen; sink and bar in community room for daily use
- G** Several pairs of restrooms serve pool, community room, and fitness area
- H** Pool equipment, utility rooms, and janitorial closet set away from activity areas
- I** Covered terrace with exposed beams and volume ceiling
- J** Exterior staircases to fitness room
- K** Covered deck off fitness room offers view of pool